



SHIRE OF  
**HARVEY**

# Harvey Community Precinct

Master Plan 2021





SHIRE OF  
**HARVEY**

# 1. Design Approach



**Harvey**  
Community  
Precinct

SITE CONTEXT AND CHARACTER

Harvey has a rural character shaped by its long standing agricultural industries and an Indigneous heritage shaped by its history and pre-colonial landscape named ‘Korijekup’.



The projects sits within the Shire of Harvey bounded by Uduc Road (South), Young Street (West) Gibb Street (North) and Becher Street (East).

To the West sits the Harvey Recreation Grounds and ANZAC War Memorial, Harvey Primary School to the North with eastern and southern numerous lots.



SITE HERITAGE SIGNIFICANCE AND SITE ADAPTATION

The significant heritage buildings (highlighted in yellow) that are to be retained currently sit disconnected in the landscape. The removal of existing buildings (grey - non-heritage) will allow clear north-south, east-west connectivity and reclaim the heritage landscape.

- 1. **Harvey Town Hall**- adapted to be the Arts, Culture and Tourism Centre - performing arts, exhibition, galleries, creative arts rooms and studios, and Artist residency.
- 2. **Shire Administration Building** - retaining clock facade with skeletal pergola structure behind - demolishing the remainder.
- 3. **War Memorial Library** - retaining the front facade and introducing a transparent building extending beyond the original footprint with internal chamber within its volume.
- 4. **Catholic Church** - retained and adapted as an event space.
- 5. **RSL Hall Community Resource Building** - remains as community resource centre.

\*\* See Appendix for Heritage Report

CURRENT SITE AND HERITAGE SIGNIFICANCE

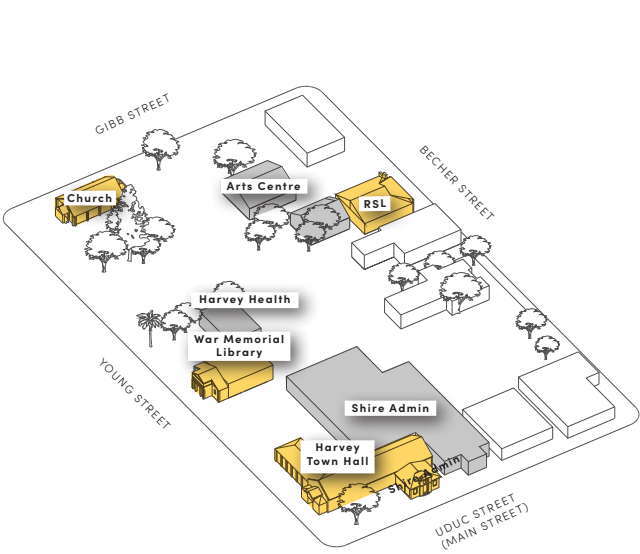

ESTABLISH SPINE TO ACTIVATE STREETSCAPE & ALLOW FOR NEW CONNECTIONS AND ACTIVITY

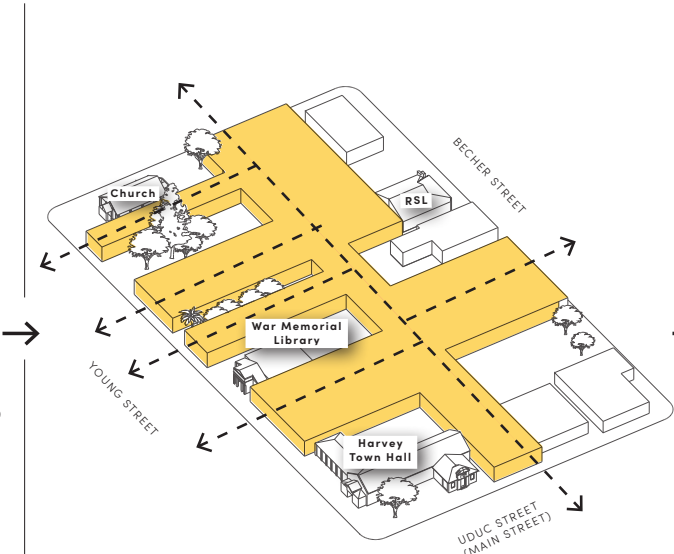

BUILDING HERITAGE SITE ADAPTATION

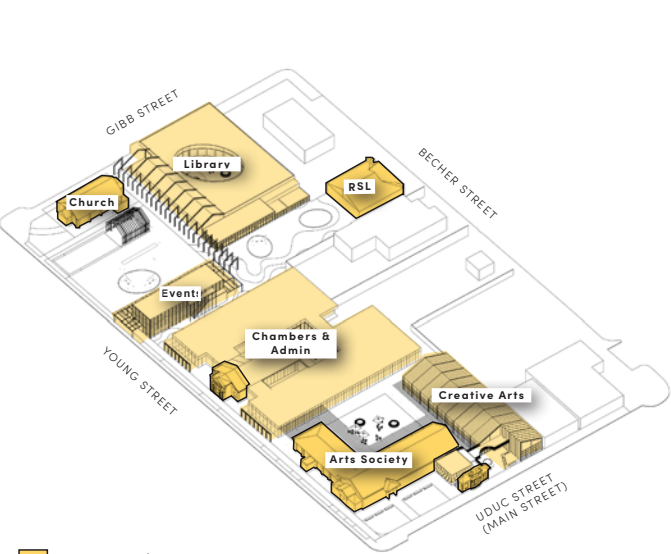

Retained Heritage  
New Development



TREE RETENTION

Numerous large and heritage trees on the site are retained and framed by building additions.

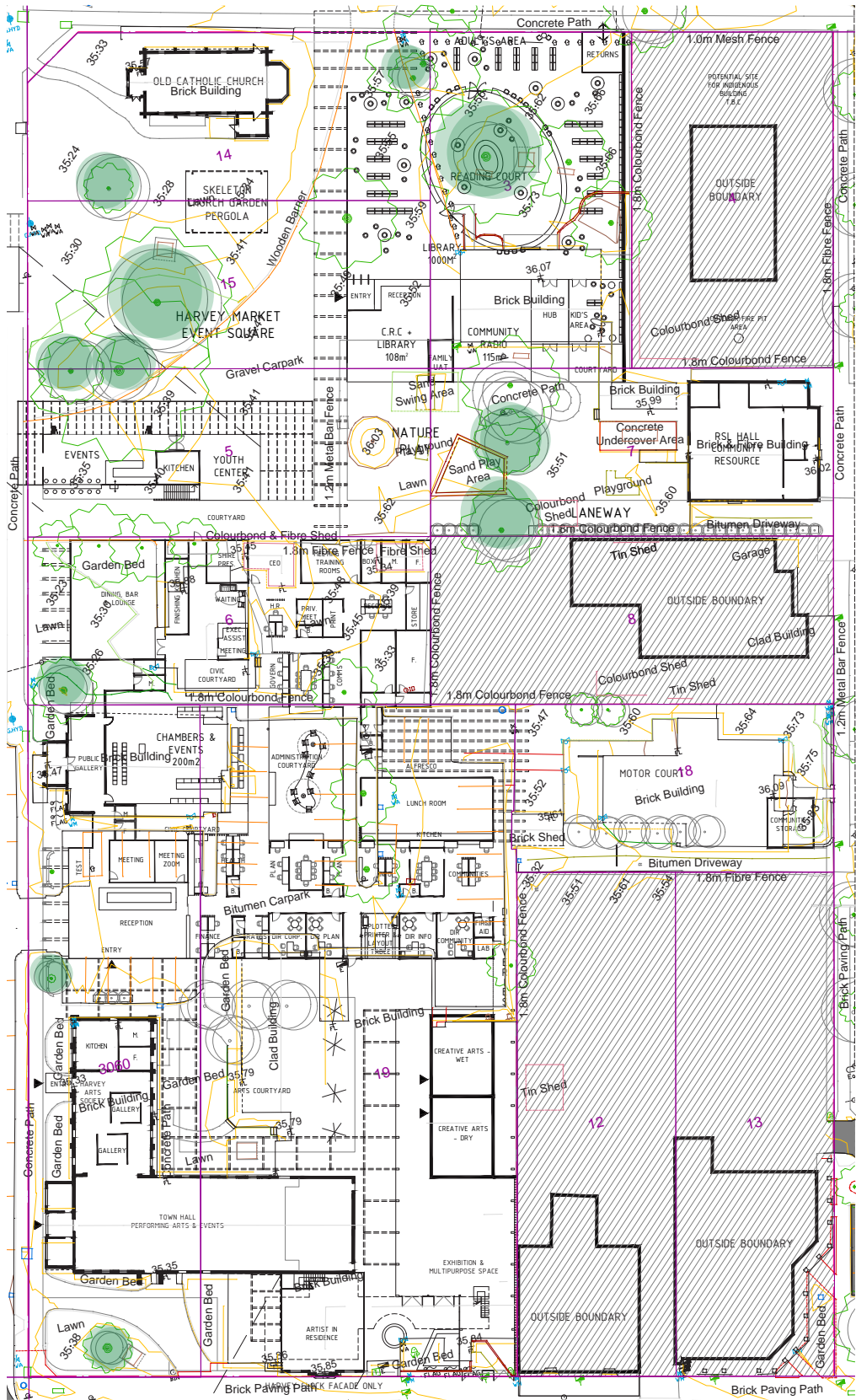



# DESIGN APPROACH - KEY DRIVERS

## MASTERPLANNING TO CREATE HARVEY'S IDENTITY

The Masterplan approach will reclaim Harvey's identity through 3 principles :

- 1. CELEBRATE THE HISTORY** - Connect and frame the heritage buildings as beacons within the precinct to restore regional character and celebrate history.
- 2. CREATE A PLACE FOR THE COMMUNITY** - Create a Hub and focal point for the 28,000 people living across the Shire. A relatable, identifiable and usable place which responds to residents now and into the future (considering a changing demographic).
- 3. SHOWCASE SHIRE OF HARVEY** - Curation of an experience that is memorable and unique to showcase Harvey with a flexible precinct for its history, arts, culture, civic and local produce.

## CREATION OF 3 CONNECTED PRECINCTS

Three connected precincts are strategically located to strengthen connections, create relationships and activate historic buildings, new buildings, existing facilities and streetscapes. This definition also provides for Event Mode within each precinct.

Community & Learning	Civic Chamber & Administration	Arts, Culture & Tourism
<b>Locate:</b> Direct link to Primary School & Sporting Grounds to deliver a support facility	<b>Locate:</b> Direct Link War Memorial - Using War Memorial Library as Beacon	<b>Locate:</b> Direct link to Main Street (Uduc) to activate & invite Tourism
<div>+ Library, Community Resource Centre and Radio</div> <div>+ Events, Youth Room and Start- up</div> <div>+ Market Lawn &amp; Event Space</div> <div>+ Public Meeting Rooms</div> <div>+ RSL</div> <div>+ Nature Play</div>	<div>+ Civic Chamber</div> <div>+ Civic Administration</div> <div>+ Civic Courtyard (For Ceremonies)</div> <div>+ Civic Meeting Rooms</div> <div>+ Civic Garden Opportunity</div> <div>+ Linked to Civic Lane with Events</div>	<div>+ Exhibition and Multipurpose Space</div> <div>+ Creative Arts Group and Studios</div> <div>+ Artist in Residence and Gallery</div> <div>+ Harvey Arts Society &amp; Gallery</div> <div>+ PerformingArts and Events</div> <div>+ Arts Courtyard</div> <div>+ Tourism Information</div>

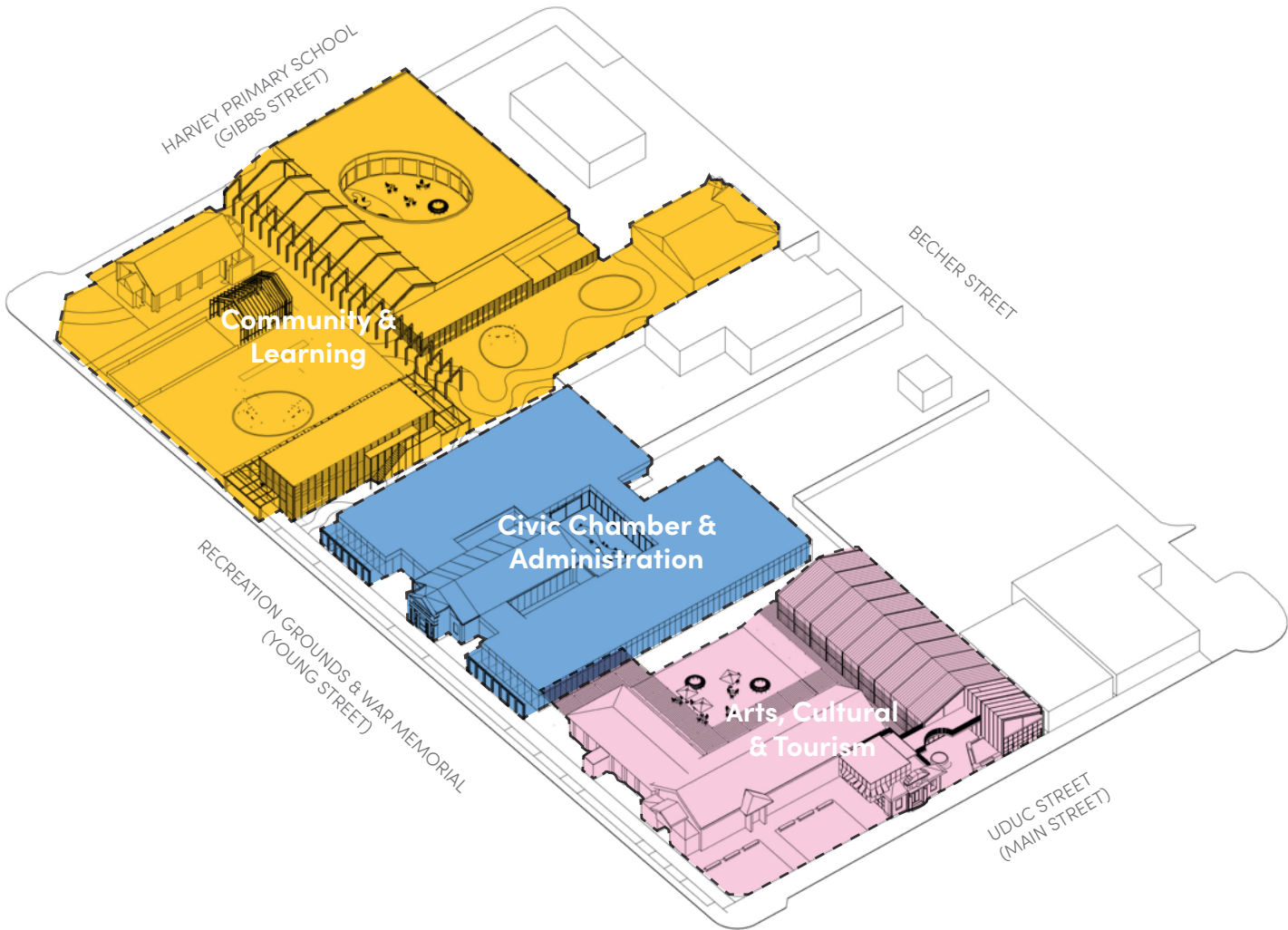



# DESIGN APPROACH

## RE-ESTABLISHING STREET EDGE, SITE AXIS AND ENTRY POINTS

Establishing North/South and East/West spines with key entry points to connect the precinct to the Primary School, the Playing Fields, Main Road and Becher street.

Re-establishing the street edge to restore the heritage buildings presence on the street scape.

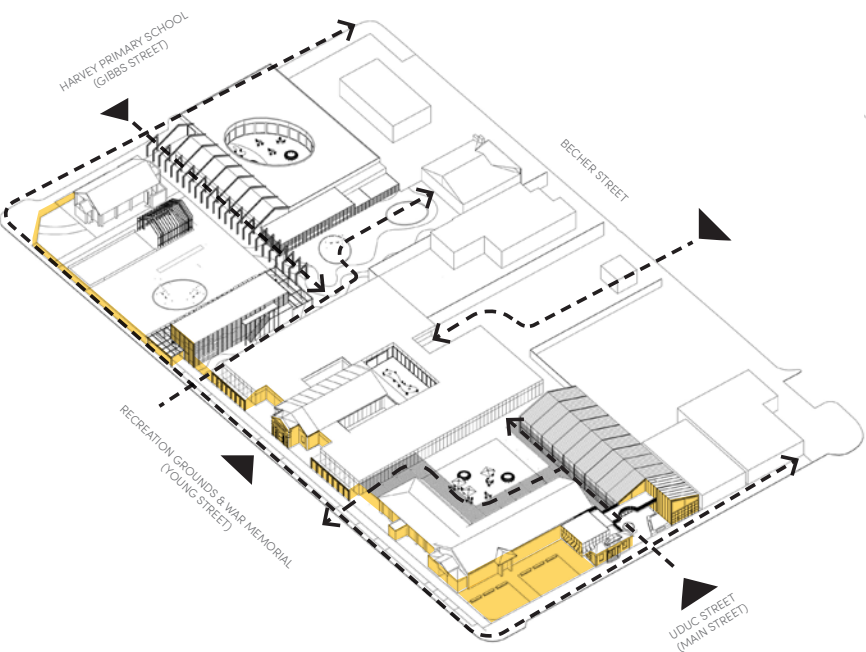

## CONNECTION TO OUTSIDE VIA INTERNAL COURTYARDS AND ARBOURS

Internal courtyards allow retention of trees and Northern light to flood into both new and old buildings.

Adoption of portal frame structures act as green links, providing both outdoor shelter and connecting key points.

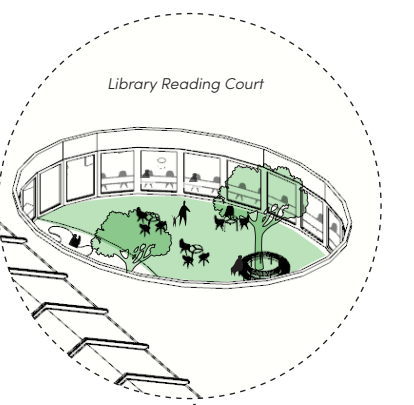
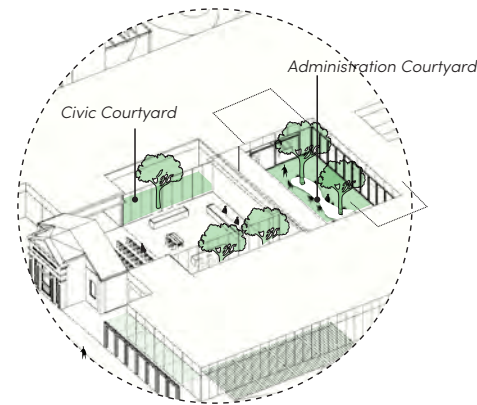
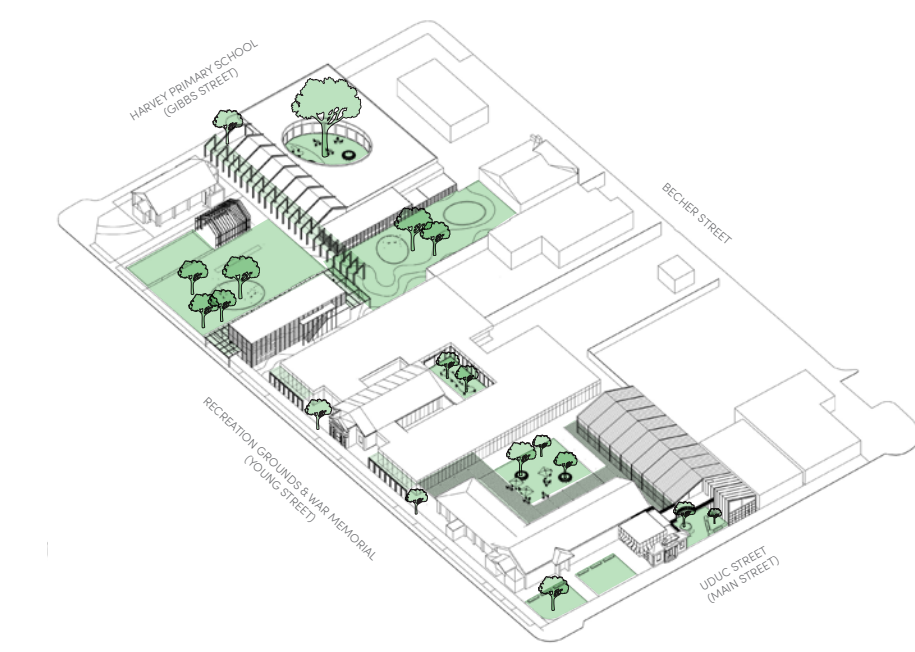

## SITE RESPONSE TO CONTEXT, CHARACTER AND FORM

A progressive architectural form extending North, South, East and West connects the precinct, the heritage buildings and the street edge, paying homage to Harvey's history and wider agricultural context through symbolism and scale. The various facilities unravel across the site, creating a connected precinct punctuated with open courtyards, meeting places and expanded site lines.

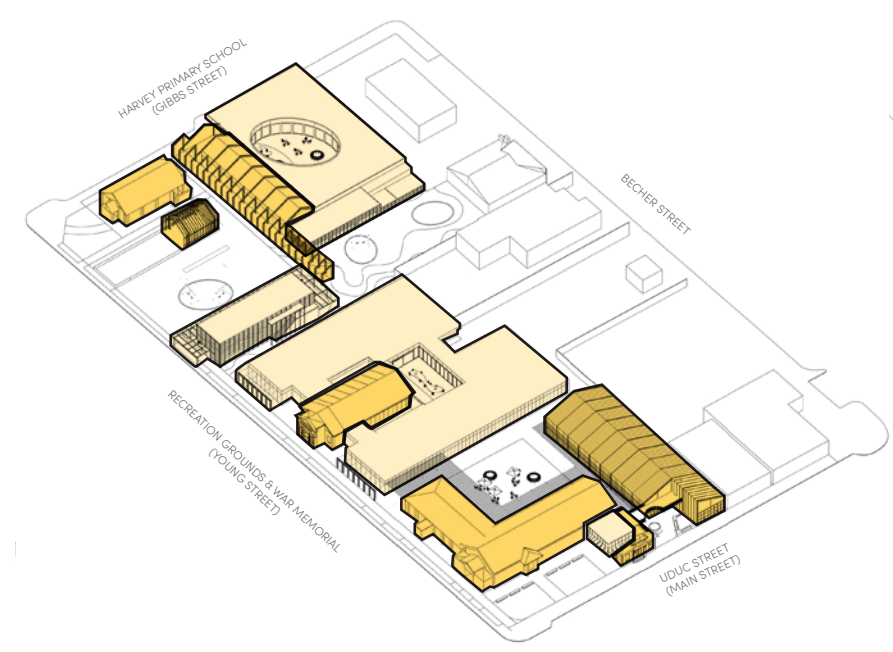

The simplicity, relatability and contextual relevance of a farmhouse shed – sloping roofs and exposed trusses is the common thread, contrasted with contemporary adaptations of portal frames as arbors, steel and timber cladding.

Facades respond to passive solar orientation with north / south with larger voids, east / west more subdued voids and all facades have desired shading.

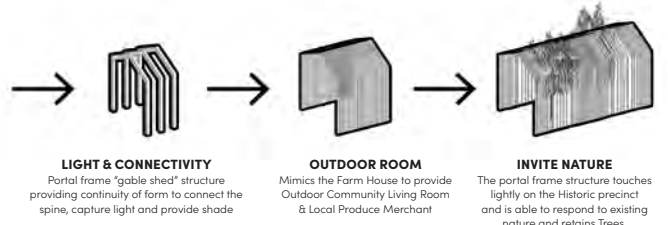
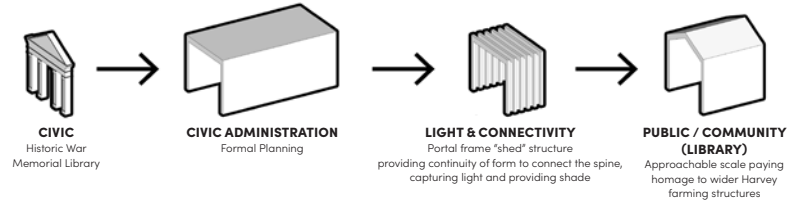



# DESIGN APPROACH

## BENCHMARKS

The following benchmarks reflect a connected sense of place through spatial fluidity, human-scale design and warm materials.

## SPATIAL





MATERIAL



Sands End Arts and Community Centre, London



Salle Des Fetes De Pratgraussals, France



PXL-MAD School of Arts, Belgium



School Complex Gloggnitz, Austria



Yolanda Ceballos Caroline University - Phase 1, Mexico



Galleria Gentili, Italy





SHIRE OF  
**HARVEY**

## 2. Site Plan



**Harvey**  
Community  
Precinct



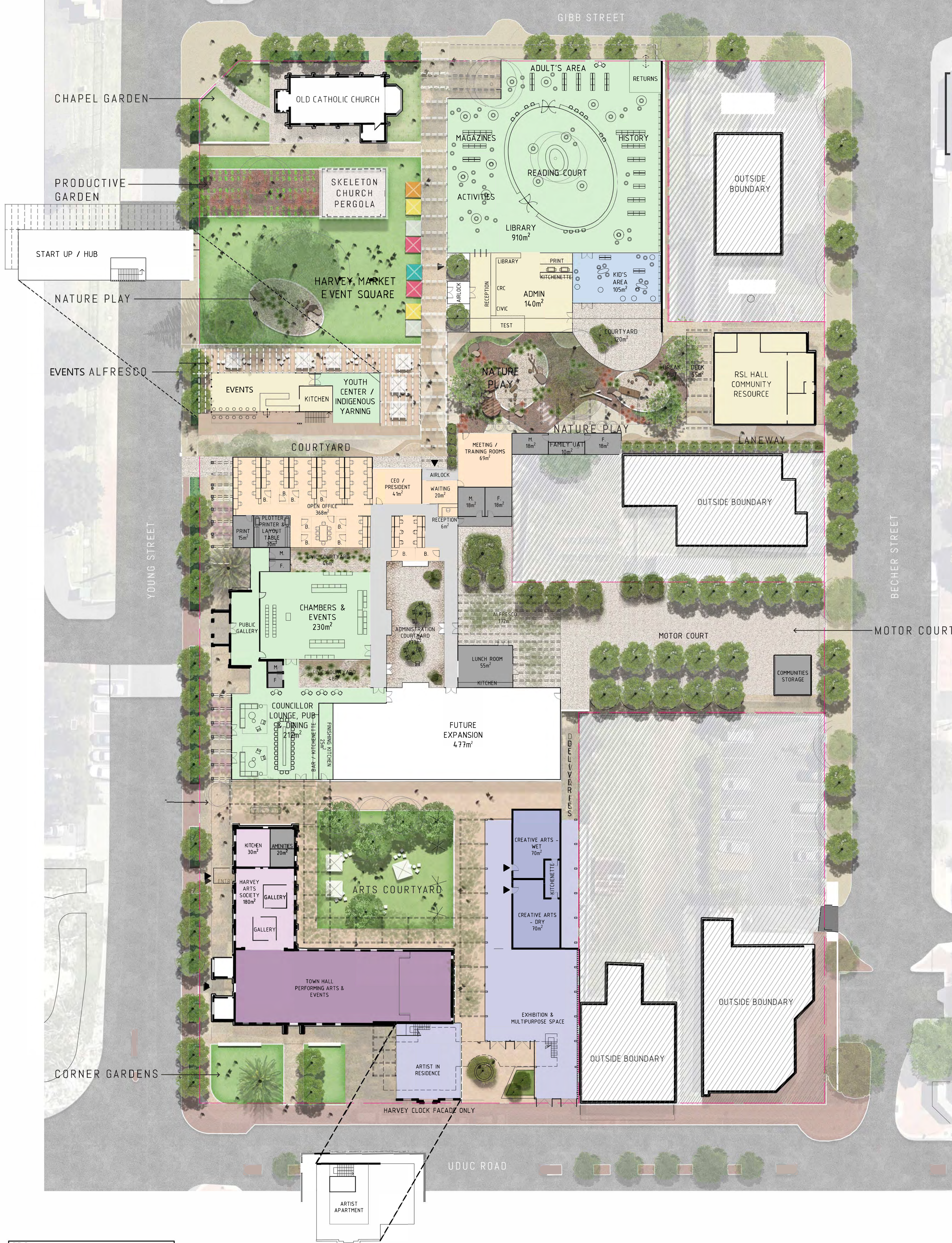

TITLE HARVEY COMMUNITY HUB MASTER PLAN		
DRAWING GROUND FLOOR SITE PLAN		
SCALE : 1:250 @ A1	Figured dimensions take precedence over scale. Verify dimensions on site.	
JOB No. 20027	DRG. No. SK101	REVISION E

COPYRIGHT  
This drawing is copyright and the property of  
Christou Design Group Copyright Act and must not be  
retained, copied or used without authority.

**CHRISTOU**  
ARCHITECTURE / URBAN DESIGN / INTERIOR DESIGN



SHIRE OF  
**HARVEY**



**JULY 2:30PM**



**GIBBS STREET - LIBRARY, CHURCH**



**UDUC ROAD ELEVATION - TOWN HALL, ARTIST RESIDENCE, EXHIBITION HALL**

\* Artists impressions don't include true depiction of Town Hall and Church buildings



JULY 2:30PM



YOUNG STREET ELEVATION - CHAMBERS, TOWN HALL



YOUNG STREET ELEVATION - CHURCH, MARKET LAWN

\* Artists impressions don't include true depiction of Town Hall and Church buildings





SHIRE OF  
**HARVEY**

## 3. Space Planning - Library



**Harvey**  
Community  
Precinct



# SPACE PLANNING

High level space planning has been developed to confirm the adequacy of the areas detailed in the masterplan. Schematic design and design development is required to satisfy the agreed brief.

## LIBRARY

Two large trees in front of the existing arts centre on Gibb street shape the planning of the Library with the use of an elliptical reading court to accommodate their retention. The Gibb street arrival is also shaped by a retained mature tree.

There are two entry points - one at the North-West corner of the building via Gibb street and the one accessed from within the precinct at the Western edge of the building connecting the library to the Market Lawn as well as the playing fields over Young Street.

The open plan of the Library is accompanied by a pertinent quarter at its rear, with closed rooms to house the reception, CRC, Community Radio, Hub and Kid's Area.

The library maximises on spatial flexibility accommodating free standing bookshelves, with wall shelving running along the eastern edge.

The circulation of the library revolves around the reading courtyard for visual and spatial continuity as well as experience within nature.

Seating becomes an extension of the elliptical courtyard lending itself to a continuous and open space expanded by the direct light recieved from the open air void. The existing trees provide adequate diffusion of this light.

Extensive glazing on the Northern and Western edges connect the space to Gibb street and the Harvey Market Square.

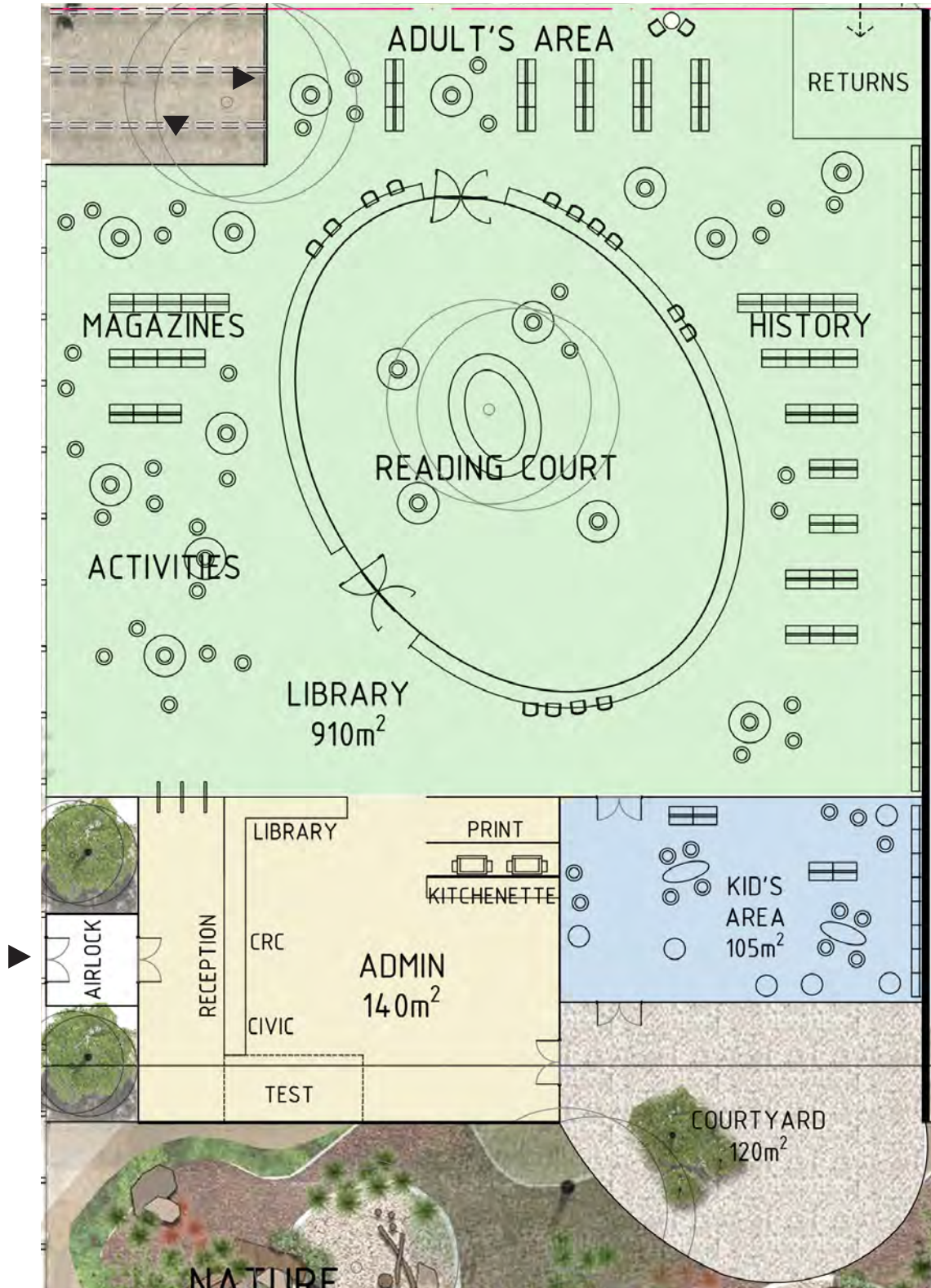
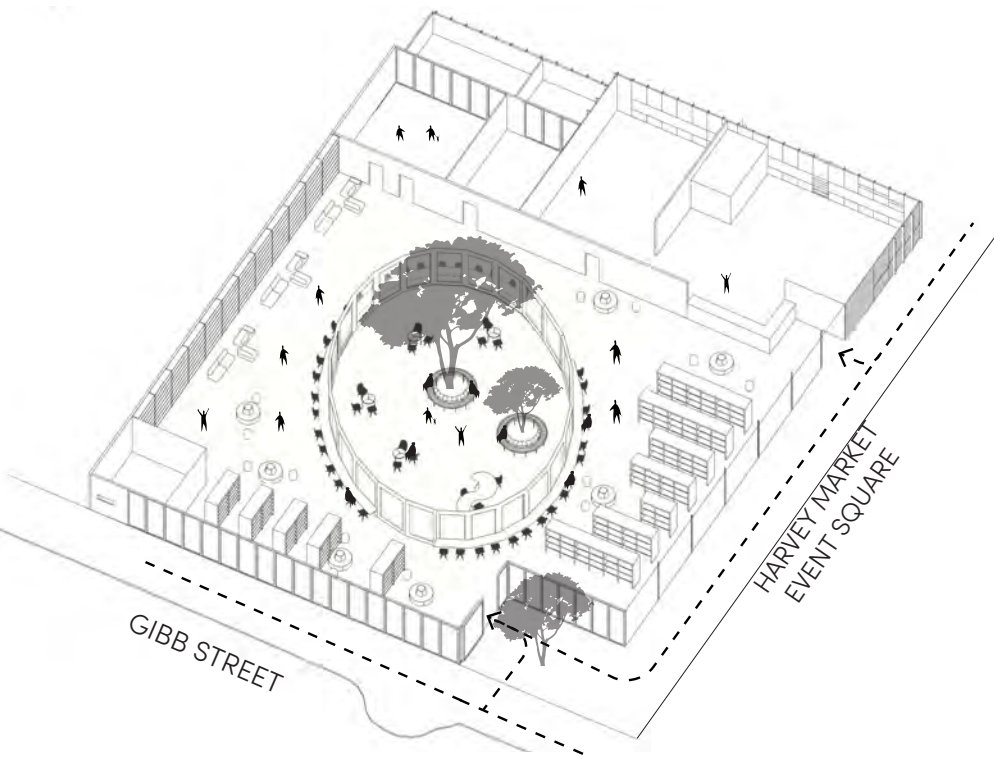



## LIBRARY VISUALISATIONS



Library Kids Area/Pre School



Library Reading + Study Western Edge



Library Reading + Study Eastern Edge



Library Reading Courtyard





**LIBRARY KIDS AREA**





**LIBRARY READING + STUDY WESTERN EDGE**





**LIBRARY READING + STUDY EASTERN EDGE**





**LIBRARY READING COURTYARD**





**LIBRARY READING COURTYARD - AERIAL**





SHIRE OF  
**HARVEY**

## 4. Space Planning - Events / Multipurpose



**Harvey**  
Community  
Precinct



SPACE PLANNING (CONTINUED)

EVENTS/MULTIPURPOSE

Events internal seating with ample alfresco seating run the northern and eastern perimeter looking out onto the outdoor Market Event Square.

The kitchen is flexible-use or leased to operator and can be used for commercial kitchen and council dinners.

A youth centre connected to the events and alfresco is linked to to the co-working area on the upper floor (accessed from an exterior staircase).

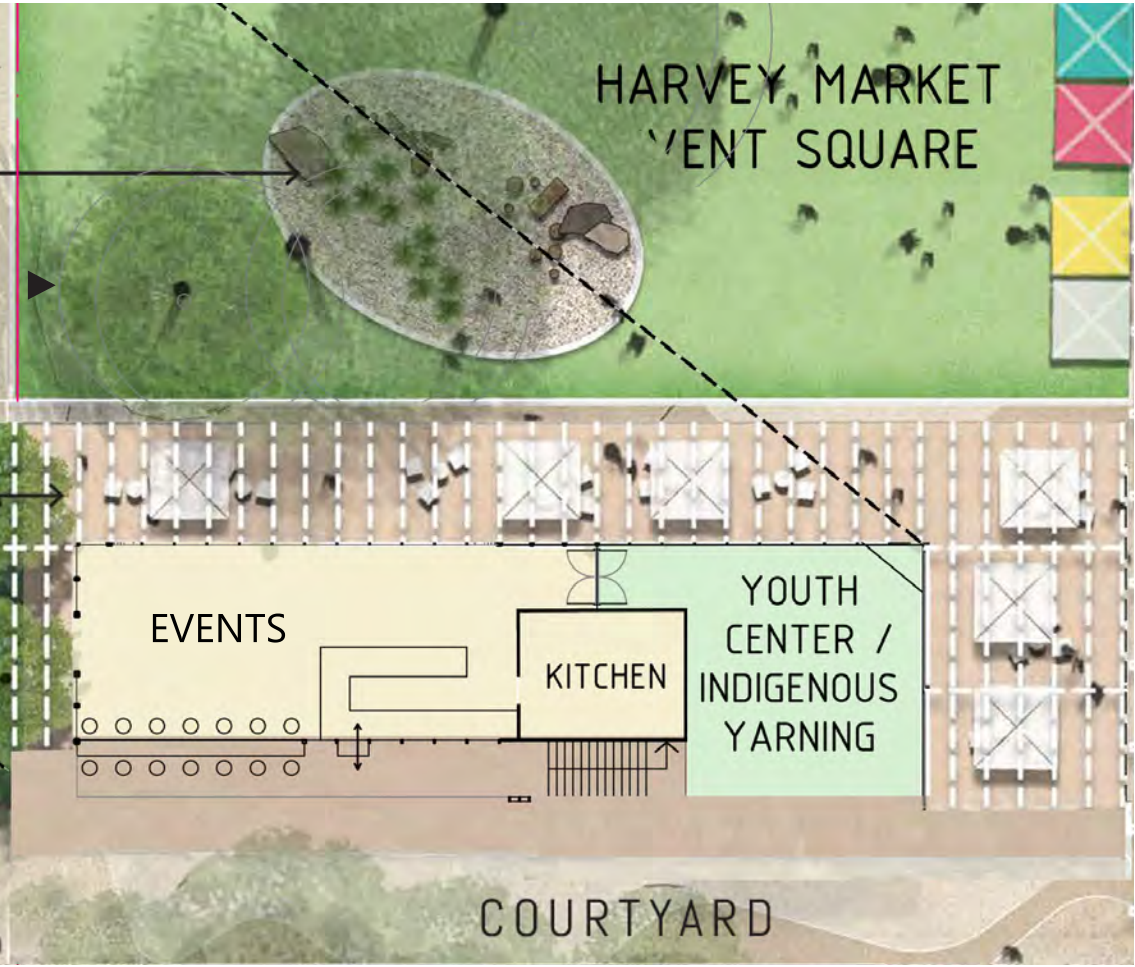
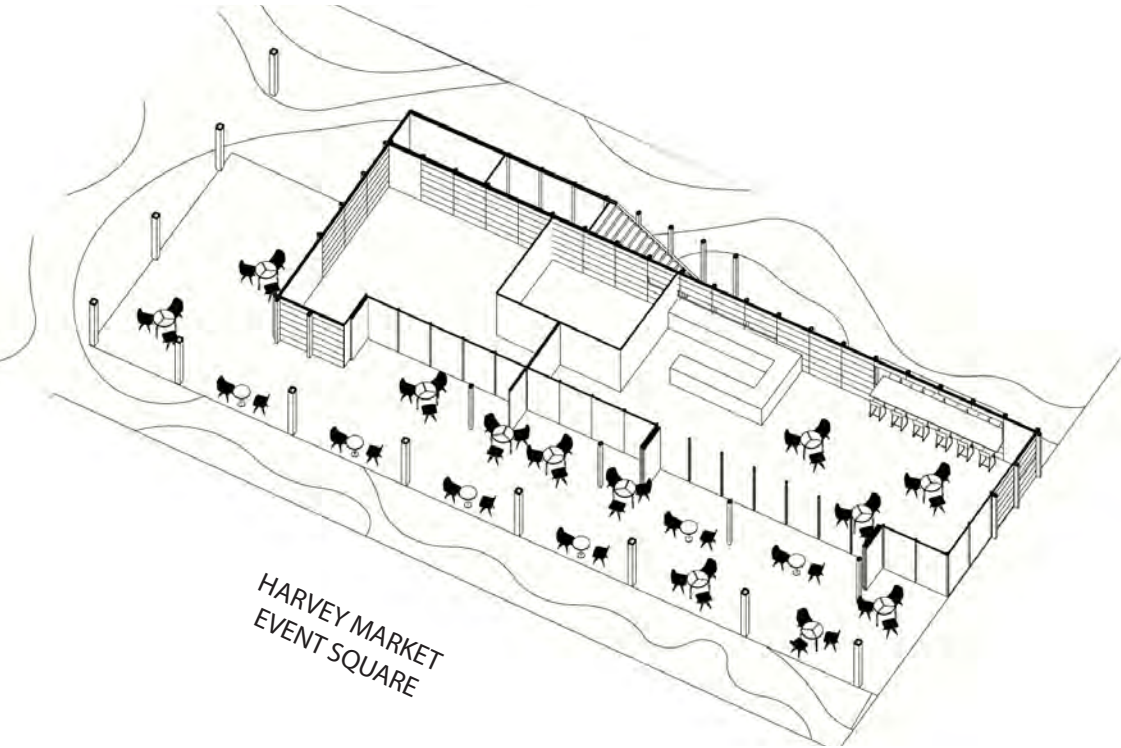



## EVENTS / MULTIPURPOSE VISUALISATIONS



Events Alresco Area



Events Alfresco Area Looking onto Market Lawn



Events Alresco Area - Under the Vines



Events Interior





**EVENTS - ALFRESCO AREA**





**EVENTS ALFRESCO AREA LOOKING ONTO MARKET LAWN**





**EVENTS ALFRESCO AREA**





**EVENTS - INTERIOR**





SHIRE OF  
**HARVEY**

## **5. Space Planning - Council chamber and administration**



**Harvey**  
Community  
Precinct



SPACE PLANNING (CONTINUED)

COUNCIL CHAMBER AND ADMINISTRATION

CHAMBERS AND EVENTS

- + **Public Gallery** - Entrance into the Chambers via the public gallery, which can convert to cater for an additional 50 people for council meetings when opened to the chambers.
- + **The Chambers** - is a restrained and elegant space welcoming but with the gravitas of an official building. It is the focal point of the plan, with two civic courtyards on the northern and southern edges of the room that expand the space with light and greenery. The retention of the War Memorial Library facade lends itself to the official arrival experience. Its primary use is for council meeting, public seating and has the flexibility to be used by other users and events.
- + **Councillor Dining, Bar and Lounge** - Connected to the Chambers and Public Gallery, this space is used before and after meetings and events, and abuts onto Young Street for showcase purposes. The space provides for a long table set up for 20-30 people. The bar has the ability to be open or concealed.
- + **Shire President Office** - can be accessed externally and is located near to the CEO's office.

FRONT OF HOUSE

- + Main entrance from thoroughfare connected to Young Street, acting as a 'pre-lobby' to allow for larger groups.
- + The reception allows for physical separation of customers.
- + Licencing test booth located near reception.
- + Two small meetings rooms with operable walls have private and public access.

OFFICES, MEETING AND FACILITY (see Facilities Schedule for more detail)

- + Open plan office workstations in the southern quarter of the building are accessed from reception and privately from the Arts Courtyard. The work space is connected to the lunchroom and alfresco eating area.
- + Meeting and training rooms are positioned at the northern quarter with access to the cafe laneway.
- + Planning, Health, Governance and Communities workstations have a direct link to the Administration Courtyard.

ADMINISTRATION COURTYARD

- + Central focal point and light void to expand adjacent circulation corridors and offices.
- + The courtyard can be used as both a workspace and events.





**CHAMBER & ADMINISTRATION VISUALISATIONS**



**Chamber + Administration - Young Street Facade**



**Chamber Interior**



**Administration Courtyard**



**Chamber - Looking onto Civic Courtyard**





**CHAMBER & ADMINISTRATION YOUNG STREET FACADE**





**CHAMBER & ADMINISTRATION**





**CHAMBER & ADMINISTRATION - CIVIC COURTYARD**





**ADMINISTRATION COURTYARD**





SHIRE OF  
**HARVEY**

## **6. Space Planning - Arts, exhibition, gallery and artist residency**



ARTS, EXHIBITION, GALLERY AND ARTIST RESIDENCY

- + Arrival into the exhibition space is framed by a forecourt on Uduc Road. The exhibition space is open-plan with high ceilings, enveloping an enclosed mass of two Creative Arts Studios, allowing visitors to view live creative studios and the process of making.
- + An arbor overhead directs pedestrians from the Uduc Road and Young Street into an intimate Arts Courtyard.
- + The Town Hall Performing Arts and Events is accessed via Young Street and is linked to the Arts and Society Gallery spaces to showcase Shire and local artwork.
- + A Kitchenette at the north is used for tea, wine, cheese and cake service.
- + The Arts Courtyard is perceived as the heart of the Arts Precinct and accommodates for events and large congregations. From a planning perspective, the courtyard allows division of creative space types and also allows northern light to flood studio and gallery spaces.
- + The Corners Garden activates the street edge by visually and spatially connecting the Town Hall with the Artist in Residence.





**ARTS, EXHIBITION & GALLERY VISUALISATIONS**



**Multi- Purpose Exhibition Space- Looking South**



**Multi-Purpose Exhibition Space - Looking North**



**Multi-Purpose Exhibition Space - Entry**



**Entry Court to Arts Precinct**





**MULTI PURPOSE EXHIBITION SPACE**





**MULTIPURPOSE EXHIBITION SPACE**





**MULTIPURPOSE EXHIBITION SPACE - ENTRY**





EXHIBITION/STUDIOS & ARTS COURTYARD