

RIDLEY PLACE FORESHORE

MASTERPLAN UPDATE

Prepared for Shire of Harvey

06.07.2023 REV (D)





LEGEND

- | | | | | |
|--|--|---|--|---|
| 01 LOT 209 POCKET PARK WITH ELEVATED VIEWING BOARDWALK AND MOUNDED TURF GRASSING | 08 PEDESTRIAN LINK TO AUSTRALIND COMMUNITY PRECINCT | 15 FULLY SERVICED FOOD VAN SITE / FACILITIES WITH PATH ACCESS | 22 EXISTING PARKING INCLUDING NEW HERITAGE TRAIL HEADER SIGN | 29 REALIGNED UNIVERSAL ACCESS PATH |
| 02 EXISTING ROUND ABOUT | 09 NEW CAFE AND PUBLIC FACILITIES | 16 ADDITIONAL PICNIC FACILITIES | 23 UNIVERSAL ACCESS PATH WITH FITNESS STATIONS THROUGHOUT | 30 RESTORED OR/AND RELOCATED PIONEER MEMORIAL |
| 03 RECONFIGURED BUS EMBAYMENT WITH REVISED PEDESTRIAN ACCESS AND ISLAND REFUGE | 10 EXISTING PLAYGROUND | 17 RELOCATED AND SERVICE ACCESSIBLE WATER TREATMENT SWALE EMBEDDED IN FORESHORE LANDSCAPE | 24 FEATURE GARDEN | 31 POTENTIAL PIONEER MEMORIAL RELOCATION TO MEMORIAL PARK WITH PARK ENHANCEMENT |
| 04 RECONFIGURED AND EXTENDED CAR PARK | 11 DAILY COFFEE VAN SITE (SUBJECT TO CAFE LEASE) | 18 INFORMAL KICK ABOUT AND NON FOOD MARKET, EVENTS (UNSERVICED) (SURFKITE OVERFLOW) | 25 RESTORED FORESHORE VEGETATION | 32 POTENTIAL ANZAC MEMORIAL AND LOOKOUT SHELTER |
| 05 POTENTIAL ADDITIONAL PARKING AND BOAT PARKING BAYS | 12 INFORMAL PLAY AND RUN ABOUT WITH PASSIVE SURVEILLANCE OPPORTUNITIES | 19 EXISTING ARTWORK WITH NEW SURROUND | 26 FORMALISED TURF GRASSING TO RESTORED FORESHORE | 33 NEW PICNIC SHELTER WITH BARBECUE FACILITIES |
| 06 EXISTING PEDESTRIAN CROSSING WITH ENHANCED PEDESTRIAN ENTRY POINT | 13 RIDLEY PLACE FEATURE ENTRY AND CAR PARK SCREEN | 20 NEW INFORMAL SEATING/ VIEWING | 27 BEACH ACCESS WITH SURF KITE FACILITIES | 34 NEW BENCH SEATING |
| 07 NEW ROUND ABOUT WITH ADDITIONAL BANNER POLES TO CENTRAL MEDIAN | 14 EXISTING WATER TREATMENT WITH NEW INTERPRETATION SCREEN | 21 POTENTIAL CHRISTMAS TREE SITE | 28 PROPOSED BASKETBALL 3 ON 3 HALF COURT | 35 EXISTING PEDESTRIAN CROSSING WITH ENHANCED PEDESTRIAN SAFETY MEASURES |
| | | | | 36 POTENTIAL FORMALIZED PEDESTRIAN CROSSING |



**NORTHERN POS
NTS**

37 PASSIVE RECREATION AREA / POTENTIAL ANZAC PRECINCT

RIDLEY PLACE FORESHORE

LANDSCAPE CONCEPT PLAN
JULY 2023

JOB NO. 2211601
1:2000 @ A1

C1.104
0 20 40 80 120 200m
REV D

COPYRIGHT THIS DOCUMENT IS AND SHALL REMAIN THE PROPERTY OF PLAN E



LANDSCAPE ARCHITECTS
L1, 278 RAILWAY PDE WEST LEEDERVILLE WA 6007
T: (08) 9388 9566 E: mail@plane.com.au



LEGEND

- 01 LOT 209 POCKET PARK WITH ELEVATED VIEWING BOARDWALK AND MOUNDED TURF GRASSING
- 02 EXISTING ROUND ABOUT
- 03 RECONFIGURED BUS EMBAYMENT WITH REVISED PEDESTRIAN ACCESS AND ISLAND REFUGE
- 04 RECONFIGURED AND EXTENDED CAR PARK
- 05 POTENTIAL ADDITIONAL PARKING AND BOAT PARKING BAYS
- 06 EXISTING PEDESTRIAN CROSSING WITH ENHANCED PEDESTRIAN ENTRY POINT
- 07 NEW ROUND ABOUT WITH ADDITIONAL BANNER POLES TO CENTRAL MEDIAN
- 08 PEDESTRIAN LINK TO AUSTRALIND COMMUNITY PRECINCT
- 09 NEW CAFE AND PUBLIC FACILITIES
- 10 EXISTING PLAYGROUND
- 11 DAILY COFFEE VAN SITE (SUBJECT TO CAFE LEASE)
- 12 INFORMAL PLAY AND RUN ABOUT WITH PASSIVE SURVEILLANCE OPPORTUNITIES
- 13 RIDLEY PLACE FEATURE ENTRY AND CAR PARK SCREEN

NOTES:

EXCLUDES NEW TREE PLANTING FOR CLARITY - TREE PLANTING TO COMPRISE BOTH EVERGREEN AND SHADE TREES TO PATH AND SEATING AREAS AND FOR SHADE AND ENCLOSURE TO MULTI USE SPACES

RIDLEY PLACE FORESHORE

LANDSCAPE CONCEPT PLAN - SOUTH
JULY 2023

JOB NO. 2211601
1:500 @ A1

C1.105
0 10 20 30 50m
REV D

COPYRIGHT THIS DOCUMENT IS AND SHALL REMAIN THE PROPERTY OF PLAN E



LANDSCAPE ARCHITECTS

L1, 278 RAILWAY PDE WEST LEEDERVILLE WA 6007
T: (08) 9388 9566 E: mail@plane.com.au



LEGEND

- 04 RECONFIGURED AND EXTENDED CAR PARK
- 06 EXISTING PEDESTRIAN CROSSING WITH ENHANCED PEDESTRIAN ENTRY POINT
- 07 NEW ROUND ABOUT
- 09 NEW CAFE AND SURROUNDS
- 10 EXISTING PLAYGROUND
- 11 DAILY COFFEE VAN SITE (SUBJECT TO CAFE LEASE)
- 12 INFORMAL PLAY AND RUN ABOUT WITH PASSIVE SURVEILLANCE OPPORTUNITIES
- 14 EXISTING WATER TREATMENT WITH NEW INTERPRETATION SCREEN
- 15 FULLY SERVICED FOOD VAN SITE / FACILITIES WITH PATH ACCESS
- 16 ADDITIONAL PICNIC FACILITIES
- 17 RELOCATED AND SERVICE ACCESSIBLE WATER TREATMENT SWALE EMBEDDED IN FORESHORE LANDSCAPE
- 18 INFORMAL KICK ABOUT AND NON FOOD MARKET, EVENTS (UNSERVICED)
- 19 EXISTING ARTWORK
- 20 NEW INFORMAL SEATING/ VIEWING
- 21 POTENTIAL CHRISTMAS TREE SITE
- 22 EXISTING PARKING INCLUDING NEW HERITAGE TRAIL HEADER SIGN
- 23 UNIVERSAL ACCESS PATH WITH FITNESS STATIONS THROUGHOUT
- 24 FEATURE GARDEN
- 25 RESTORED FORESHORE VEGETATION
- 26 FORMALIZED TURF GRASSING TO RESTORED FORESHORE
- 27 BEACH ACCESS WITH SURF KITE FACILITIES
- 28 BASKETBALL 3 ON 3 HARD COURT

NOTES:

EXCLUDES NEW TREE PLANTING FOR CLARITY - TREE PLANTING TO COMPRISE BOTH EVERGREEN AND SHADE TREES TO PATH AND SEATING AREAS AND FOR SHADE AND ENCLOSURE TO MULTI USE SPACES

RIDLEY PLACE FORESHORE

LANDSCAPE CONCEPT PLAN - CENTRE
JULY 2023

JOB NO. 2211601
1:500 @ A1

C1.106
0 10 20 30 50m
REV D

COPYRIGHT THIS DOCUMENT IS AND SHALL REMAIN THE PROPERTY OF PLAN E



LANDSCAPE ARCHITECTS

L1, 278 RAILWAY PDE WEST LEEDERVILLE WA 6007
T: (08) 9388 9566 E: mail@plane.com.au



LEGEND

- 25 RESTORED FORESHORE VEGETATION
- 29 REALIGNED UNIVERSAL ACCESS PATH
- 30 RESTORED OR/AND RELOCATED PIONEER MEMORIAL
- 31 POTENTIAL PIONEER MEMORIAL RELOCATION TO MEMORIAL PARK WITH PARK ENHANCEMENT
- 32 POTENTIAL ANZAC MEMORIAL/ LOOKOUT SHELTER
- 33 NEW PICNIC SHELTER WITH BARBECUE FACILITIES
- 34 NEW BENCH SEATING
- 35 EXISTING PEDESTRIAN CROSSING WITH ENHANCED PEDESTRIAN SAFETY MEASURES
- 36 POTENTIAL FORMALIZED PEDESTRIAN CROSSING
- 37 PASSIVE RECREATION AREA / POTENTIAL ANZAC PRECINCT
- 38 PROPOSED PARRALEL CAR PARKING

NOTES:
 EXCLUDES NEW TREE PLANTING FOR CLARITY - TREE PLANTING TO COMPRISE BOTH EVERGREEN AND SHADE TREES TO PATH AND SEATING AREAS AND FOR SHADE AND ENCLOSURE TO MULTI USE SPACES

RIDLEY PLACE FORESHORE

LANDSCAPE CONCEPT PLAN - NORTH
 JULY 2023

JOB NO. 2211601
 1:500 @ A1

C1.107
 0 10 20 30 50m
 REV D

COPYRIGHT THIS DOCUMENT IS AND SHALL REMAIN THE PROPERTY OF PLAN E



LANDSCAPE ARCHITECTS

L1, 278 RAILWAY PDE WEST LEEDERVILLE WA 6007
 T: (08) 9388 9566 E: mail@plane.com.au



LEGEND

- 39 OPEN GRASSING TO MAJOR VIEW CORRIDOR
- 40 GENTLE TURF MOUNDING FOR PASSIVE SEATING AND SPECIAL DELINEATION
- 41 2500MM WIDE PEDESTRIAN ACCESS PATH
- 42 REED AND SEDGE PLANTING TO BOARDWALK SURROUND WITH OPEN TREE CANOPY OVER
- 43 LOW PLANTING TO CARPARK ENTRY
- 44 PEDESTRIAN ACCESS TO AUSTRALIND HUB
- 45 CARPARK AND SHOPPING CENTRE SCREEN PLANTING WITH SHADE AND SCREEN TREES OVER, ON BATTER
- 46 MULTI-USE ELEVATED BOARDWALK INCLUDING INTERPRETIVE ART (600MM HIGH MAX) WITH KICK RAIL
- 47 PEDESTRIAN ACCESS PATH TO SHOPPING CENTRE
- 48 CARPARK SCREEN PLANTING WITH SHADE AND SCREEN TREES OVER
- 49 OPEN GRASSING TO MAJOR VIEW CORRIDOR WITH SHADE TREE OVER
- 50 PEDESTRIAN ACCESS TO RIDLEY PARK
- 51 EXISTING DRAINAGE INFRASTRUCTURE
- 52 SEATING AND MULTI USE PODS
- ALTERNATIVE(POTENTIAL) CHRISTMAS TREE SITE

NOTES:
 EXCLUDES NEW TREE PLANTING FOR CLARITY - TREE PLANTING TO COMPRISE BOTH EVERGREEN AND SHADE TREES TO PATH AND SEATING AREAS AND FOR SHADE AND ENCLOSURE TO MULTI USE SPACES

RIDLEY PLACE FORESHORE

LANDSCAPE CONCEPT PLAN
 JULY 2023

JOB NO. 2211601
 1:200 @ A1

C1.108
 0 4 8 12 20m
 REV D

COPYRIGHT THIS DOCUMENT IS AND SHALL REMAIN THE PROPERTY OF PLAN E



LANDSCAPE ARCHITECTS
 L1, 278 RAILWAY PDE WEST LEEDERVILLE WA 6007
 T: (08) 9388 9566 E: mail@plane.com.au

SITE PLAN

LEGEND

- 1 Undercover Cafe /Restaurant + Tourism Space Entrance Area
- 2a Cafe /Restaurant
- 2b Function Space
- 2c Kiosk
- 3 Wraparound Undercover Verandah
- 4 Interpretive/Tourism Space
- 5 Graphic Entrance Wall/Identity
- 6 Service Area
- 7 Emergency Vehicle Position

LESCHENAULT
INLET

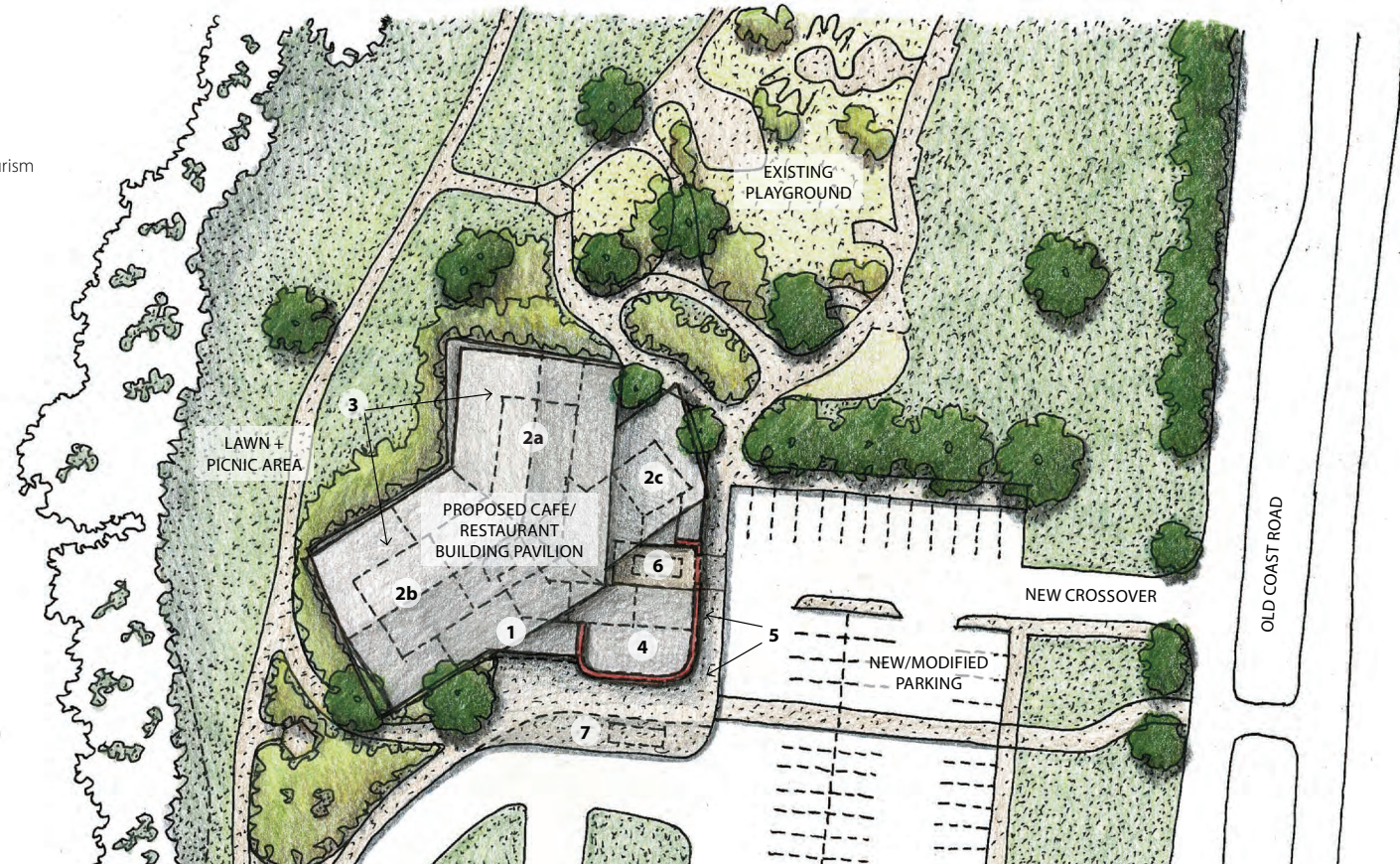

DESIGN INTENT

- THE CAFE BUILDING HAS BEEN DESIGNED SO THAT IT ESTABLISHES AN ACTIVE RELATIONSHIP WITH ALL ACTIVITIES WHICH SURROUND IT AND THE WONDERFUL VISTAS THAT THE SITE OFFERS.
- THE DESIGN CREATES A SERIES OF 'PROJECTIONS' WHICH ADDRESS AND INTERACT WITH SURROUNDINGS. THE PRIMARY CAFE/RESTAURANT SPACE FACES THE ESTUARY TO THE WEST AND NORTH AND THE PLAYGROUND TO THE NORTHEAST. THE CAFE FUNCTION ROOM ALSO FACES THE ESTUARY BUT PROTRUDES TO THE SOUTH WEST. THE KIOSK ESTABLISHES AN ACTIVE LINK TO THE PLAYGROUND TO THE NORTH AND THE TOURISM SPACE FACES THE SOUTH EAST WHILE SHARING AN ENTRANCE FORECOURT WITH THE CAFE ON THE SOUTH. A WALL INTENDED TO EMBODY A PUBLIC ART WORK FOCUSED ON LIFE IN AUSTRALIND FORMS A VISUAL WELCOME TO THE PRECINCT.
- A WIDE AND VIBRANT VERANDAH SPACE EXTENDS AROUND MOST OF THE BUILDING PROVIDING SEATING AND ALFRESCO DINING WHICH EMBRACES THE VAST VIEWS AND ENVIRONMENT OF THE SITE.
- SERVICING FOR THE BUILDING IS DISCREET AND CENTRAL WITH DIRECT ACCESS TO THE CENTRAL KITCHEN AND SERVICES PROVIDING EXCELLENT EFFICIENCIES.
- THE CENTRAL KITCHEN SPACE PROVIDES SERVICE FOR ALL PARTS OF THE CAFE INCLUDING ACCESS TO THE KIOSK.
- THE BUILDING PROVIDES TOILET FACILITIES FOR THE INTERIOR ACTIVITIES WHICH ARE ACCESSED INTERNALLY AS WELL AS PROVIDING FOR EXTERNAL USERS BY PROVIDING FACILITIES ABLE TO BE ACCESSED FROM EXTERNAL AREAS.
- THE BUILDING HAS EXCELLENT NORTHERN EXPOSURE AND WHILE VISTAS ARE MAINTAINED FROM THE NORTH TO THE WEST AND THE SOUTH THE DEPTH OF THE VERANDAHS PROVIDES SIGNIFICANT PROTECTION TO THE EXPANSE OF WINDOWS. THE EASTERN FACING FACADES ARE PREDOMINANTLY SOLID WALLS.
- MATERIALS ARE INTENDED TO FOCUS ON THEIR DURABILITY, ABILITY TO WITHSTAND THE SEVERE MARINE ENVIRONMENT, MINIMISE MAINTENANCE WHILE REFLECTING AN ELEGANT SIMPLE ARCHITECTURE MADE OF STEEL, GLASS, TIMBER SOFFITS, COLOURED CONCRETE REFLECTING THE SANDS OF THE COASTLINE AND COOL FRESH COLOURS OF THE COASTAL ENVIRONMENT.

FLOOR PLAN



LEGEND

1a	Undercover Entry	
1b	Reception	10m ²
2a	Cafe /Restaurant	125m ²
2b	Function Space	100m ²
2c	Kiosk	50 m ²
2d	Kitchen /Stores + Servery	80m ²
3	Undercover Wrap Around Verandah /Outdoor Dining	
4	Interpretive /Tourism Space	80m ²
5	Graphic Entrance Wall/Identity	
6	Indoor Accessed Toilets /UAT + Cleaner	
7	Outdoor Accessed Toilets	
8	Bin Store	15m ²
9	Plant Space	
10	Service Area	

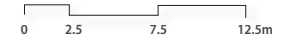

VIEW FROM SOUTH WEST LAWN

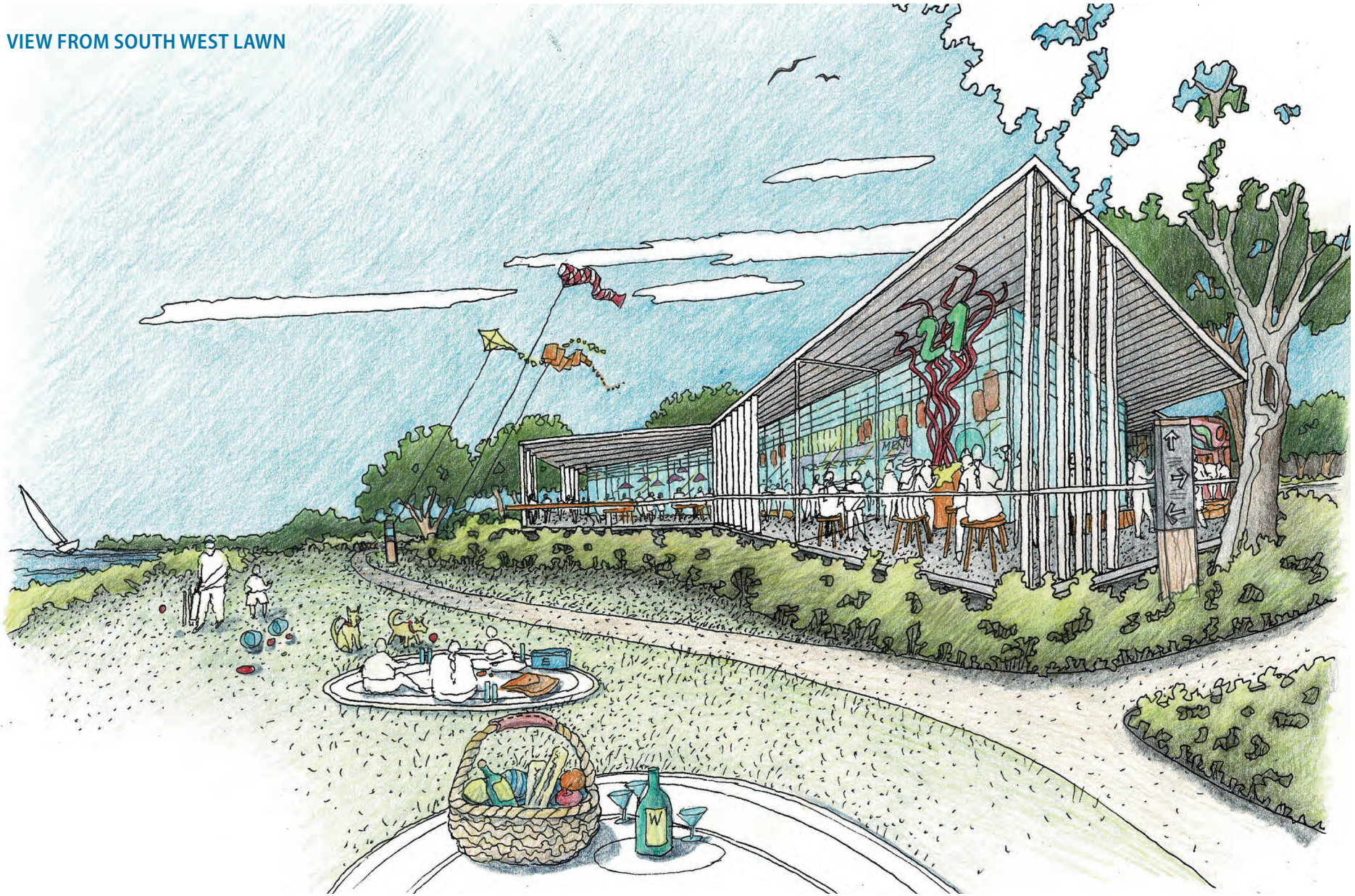

BRIEF, CONTEXT, MATERIALS & PRECEDENTS

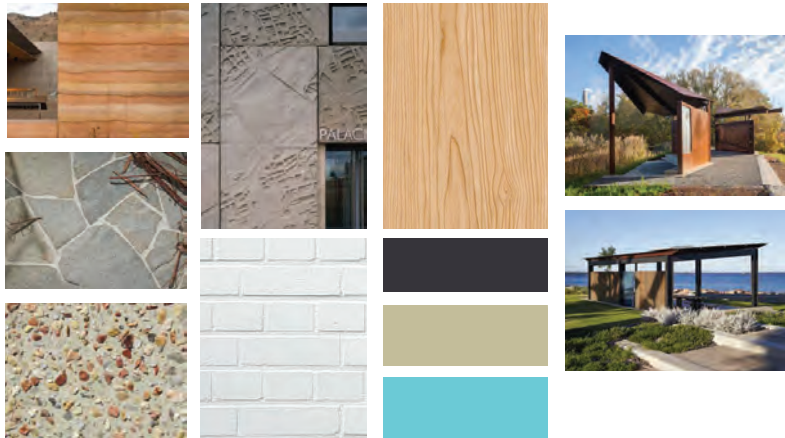

COASTAL MATERIALS PALETTE IDEAS



SEASIDE PAVILION PRECEDENTS



RIDLEY CAFE BRIEF

INTERNAL SPACES

(Allocation includes walls/circulation/etc.)

» Reception	10m ²
» Café/Restaurant	125m ²
» Function Space	100m ²
» Kiosk	50m ²
» Interpretive/Tourist Space	80m ²
» Kitchen/stores/servery	80m ²
» Bin Store	15m ²
» Indoor Toilets/UAT/Cleaner	50m ²
» Toilets/UAT accessed from outside	40m ²
» Plant Room	30m ²
» (note: analysis required to confirm all plant can be contained on ground/screened)	

EXTERNAL SPACES

- » Wrap around verandah
- » Service area
- » Undercover entry area to café/restaurant and interpretive/tourist space
- » Position for emergency vehicle
- » External perimeter landscape
- » Direct access to playground parking
- » Extensive view to playground, inlet and landscapes in all directions
- » Patterned/embossed graphic/art wall surrounding Interpretive/Tourism Space leading people to the Café entrance from car park areas.

TOTAL INTERNAL SPACES - 600m² (Gross Area)

CONTEXT DIAGRAM

